

TUTTE LE OPERAZIONI DEVONO ESSERE EFFETTUATE DA PERSONALE SPECIALIZZATO

ALL OPERATIONS MUST BE CARRIED OUT BY QUALIFIED PERSON - TOUS LES OPERATIONS DOIVENT ETRE EFFECTUEES PAR DES PROFESSIONNELLES

- ① Unscrew the 4 screws under the base.

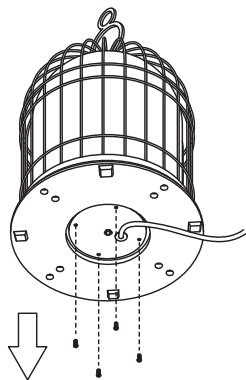

- ② Lift the structure.

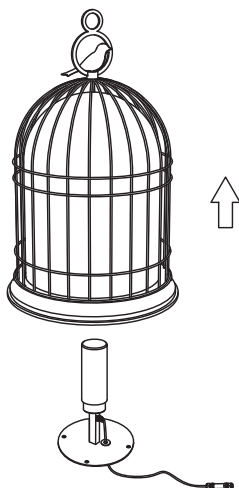

CLAMP IP68

5695/1

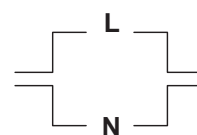

CONNECT THE CLAMP
TO THE POWER UNIT
FOLLOWING THE
ATTACHED INSTRUCTIONS

- ③ Replace the bulb.

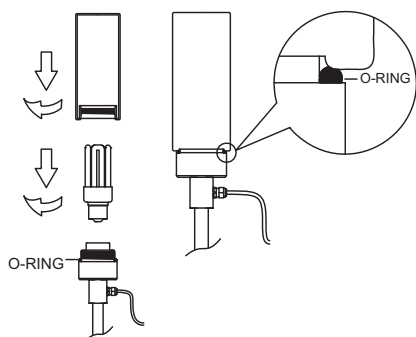

DURING THE ASSEMBLY, OR WHEN REPLACING A BULB,
VERIFY THE PRSENCE OF THE GASKET (O-RING) BETWEEN
THE RING NUT AND THE GLASS.
SCREW THE GLASS TILL THE GASKET IS COMPRESSED.
IF THE GLASS OR THE GASKET ARE DAMAGED, DO NOT
CONNECT THE POWER UNIT AND REPLACE THEM.

- ④ Mount the structure on the base and secure with 4 screws.

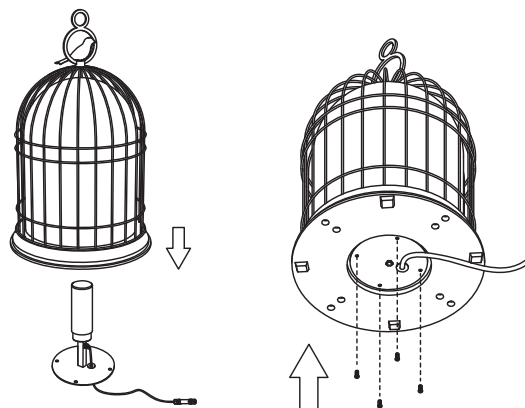

MAGNETIC FIT
FOR BIRD

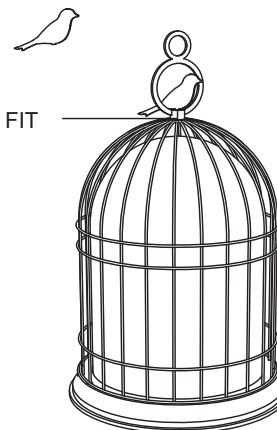

TUTTE LE OPERAZIONI DEVONO ESSERE EFFETTUATE DA PERSONALE SPECIALIZZATO
ALL OPERATIONS MUST BE CARRIED OUT BY QUALIFIED PERSON - TOUS LES OPERATIONS DOIVENT ETRE EFFECTUEES PAR DES PROFESSIONELLES

5695/1

Dispositivo di giunzione con
ancoraggio del cavo IP68
Junction device with cord anchorage IP68

2 Uscite

Connessione 3x1.5

Per cavi in neoprene

Diametro esterno cavo
(min. - max.) 5,5 - 10mm

2 Ways

Connection 3x1.5

For cables in rubber

External diameter of the cable
(min. - max.) 5.5 - 10mm

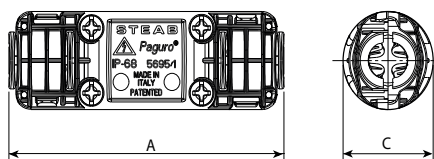

Dimensioni / Dimensions (mm)

A
70

C
23

