

ISTRUZIONI INSTALLAZIONE - INSTALLING INSTRUCTIONS - INSTRUCTIONS DE MONTAGE

2

MONTARE LA BASE E SERRARE CON FORZA LE 2 VITI.

MOUNT THE BASE AND TIGHTEN THE 2 SCREWS PROPERLY.

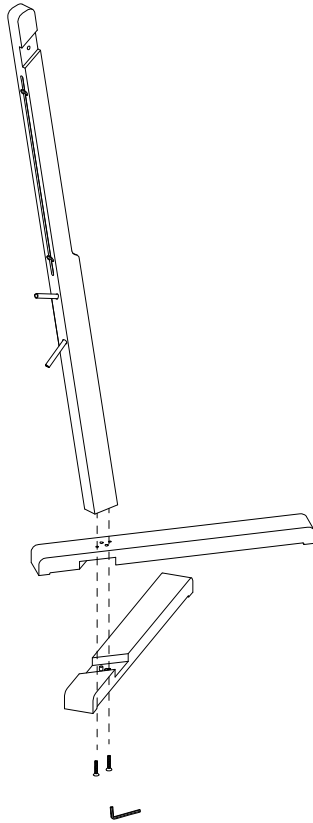

3

ASSEMBLARE IL BRACCIO E FISSARLO CON LE 2 VITI. UTILIZZARE IL DISCO DI SERRAGGIO IN DOTAZIONE.

ASSEMBLE THE UPPER BRACKET AND FIX IT WITH THE 2 SCREWS, BY USING THE TOLL SHOWN INTO THE PICTURE (FIXING DISC).

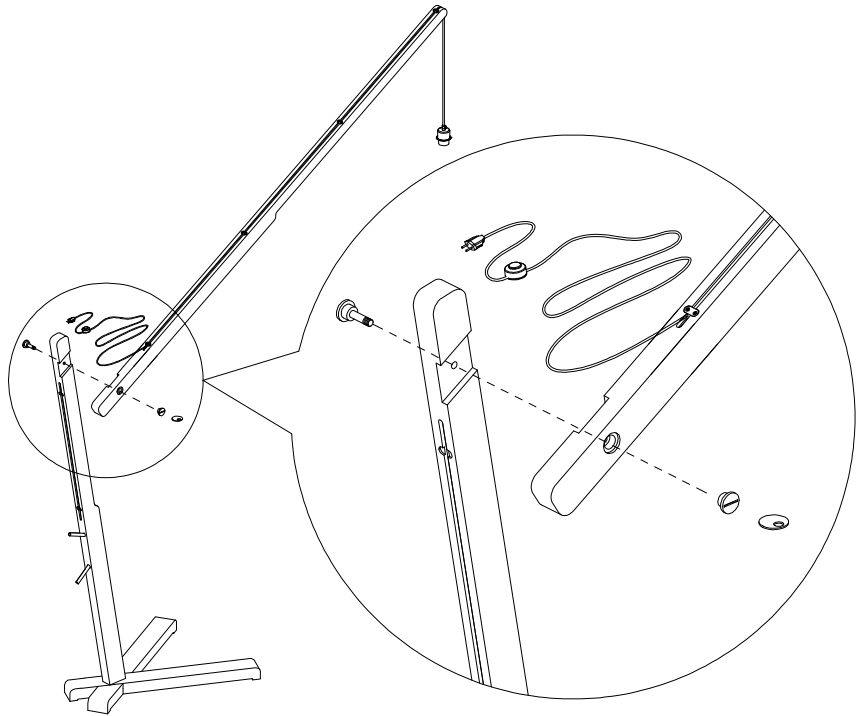

4

FAR PASSARE IL CAVO COME MOSTRATO IN FIGURA, INSERIRLO NELLA FERITOIA E FISSARLO CON 2 PIASTRE.

POSITION THE CABLE AS SHOWN INTO THE PICTURE, PLACE IT INTO THE HOLE AND FASTEN WITH THE 2 FIXING PLATES.

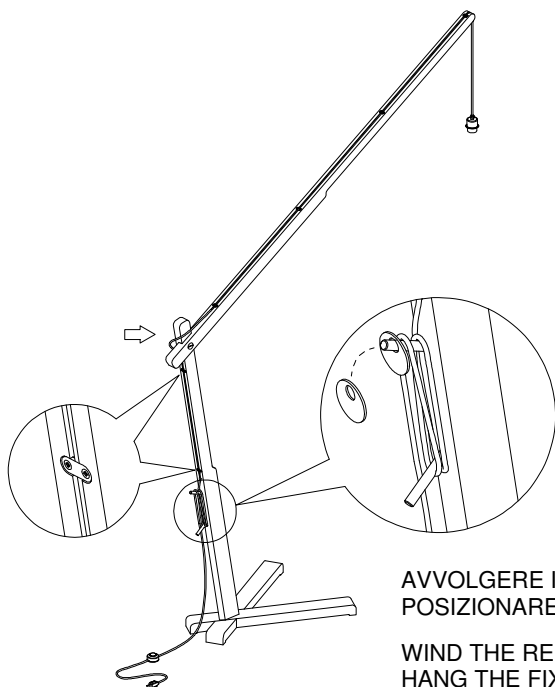

AVVOLGERE IL CAVO IN ABBONDANZA. POSIZIONARE IL DISCO DI SERRAGGIO.

WIND THE REMAINING CABLE. HANG THE FIXING DISC AS SHOWN.

5

MONTARE PARALUME - GHIERA - LAMPADINA

MOUNT THE SHADE, THE RING AND BULB

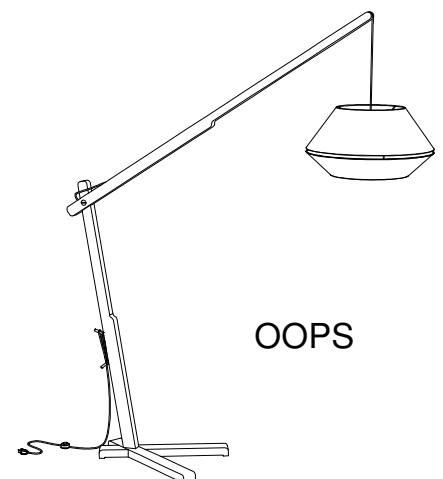
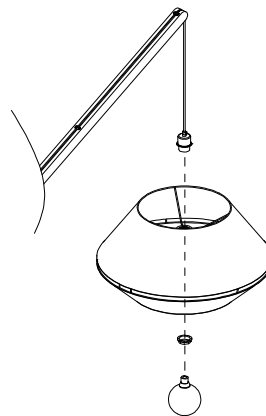

OOPS